

# XL TIMING PULLEYS

## METRIC TIMING PULLEY

0.200" Trapezoidal Pitch

For 9.5mm Wide Belts

Hub and Flanges

Aluminum

Clear Anodized

Metric Finished Bores

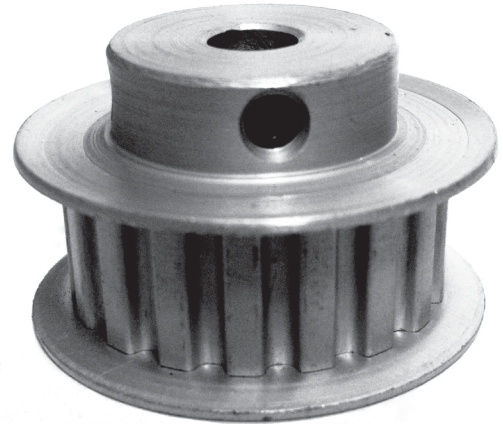

Part Number	No. of Teeth	Type	Pitch Dia. (mm)	Out. Dia. (mm)	Flange Dia. (mm)	Bore (mm)	Face Width (mm)	Overall Length (mm)	Belt Width (mm)	Hub Dia. (mm)	Set Screw
10XL037M6FA6	10	6F	16.2	15.7	22.0	6.0	14.2	20.6	10.9	10.0	M3
11XL037M6FA6	11	6F	17.8	17.3	24.0	6.0	14.2	20.6	10.9	11.0	M3
12XL037M6FA6	12	6F	19.4	18.9	25.0	6.0	14.2	20.6	10.9	13.0	2 x M3 @ 90°
14XL037M6FA8	14	6F	22.6	22.1	28.0	8.0	14.2	20.6	10.9	14.0	2 x M4 @ 90°
15XL037M6FA8	15	6F	24.3	23.7	30.0	8.0	14.2	20.6	10.9	16.0	2 x M4 @ 90°
16XL037M6FA8	16	6F	25.9	25.4	32.0	8.0	14.2	20.6	10.9	17.0	2 x M4 @ 90°
18XL037M6FA8	18	6F	29.1	28.6	35.0	8.0	14.2	20.6	10.9	21.0	2 x M4 @ 90°
20XL037M6FA8	20	6F	32.3	31.8	38.0	8.0	14.2	22.2	10.9	24.0	2 x M4 @ 90°
22XL037M6FA8	22	6F	25.6	35.1	41.0	8.0	14.2	22.2	10.9	25.0	2 x M4 @ 90°
24XL037M6FA8	24	6F	38.8	38.3	44.0	8.0	14.2	22.2	10.9	27.0	2 x M4 @ 90°
28XL037M6FA8	28	6F	45.4	44.8	51.0	8.0	14.2	23.0	10.9	30.0	2 x M4 @ 90°
30XL037M6FA10	30	6F	48.5	48.0	54.0	10.0	14.2	23.0	10.9	33.0	2 x M5 @ 90°
32XL037M6FA12	32	6F	51.7	51.2	57.0	12.0	14.2	23.0	10.9	37.0	2 x M6 @ 90°

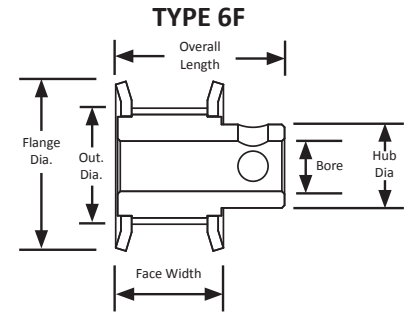

With custom manufacturing services and a full range of metric timing belt pulleys ready for immediate shipment, we can meet any company's timing belt pulley need.

Visit our catalog to choose from our selection of U.S.-made plain and finished bore stock aluminum and steel timing pulleys in metric bore sizes with metric set screws. In addition, we can cross-reference other companies' part numbers to ensure you select the right part for you.

Metric pitches include:

- |                        |                      |      |      |
|------------------------|----------------------|------|------|
| 2.03 MM (MXL)          | 2 MM POWERHOUSE™     | T2.5 | S3M  |
| 5.08 MM (XL)           | 3 MM POWERHOUSE™     | T5   | S5M  |
| 9.525 MM (L)           | 5 MM POWERHOUSE™     | T10  | S8M  |
| 3 MM POWERHOUSE™ HTD®  | 8 MM POWERHOUSE™     | T20  | S14M |
| 5 MM POWERHOUSE™ HTD®  | 14 MM POWERHOUSE™    | AT3  |      |
| 8 MM POWERHOUSE™ HTD®  | 5 MM POWERHOUSE MX™  | AT5  |      |
| 14 MM POWERHOUSE™ HTD® | 8 MM POWERHOUSE MX™  | AT10 |      |
|                        | 14 MM POWERHOUSE MX™ | AT20 |      |